

# VISTA DEL SOL

COACH HOMES

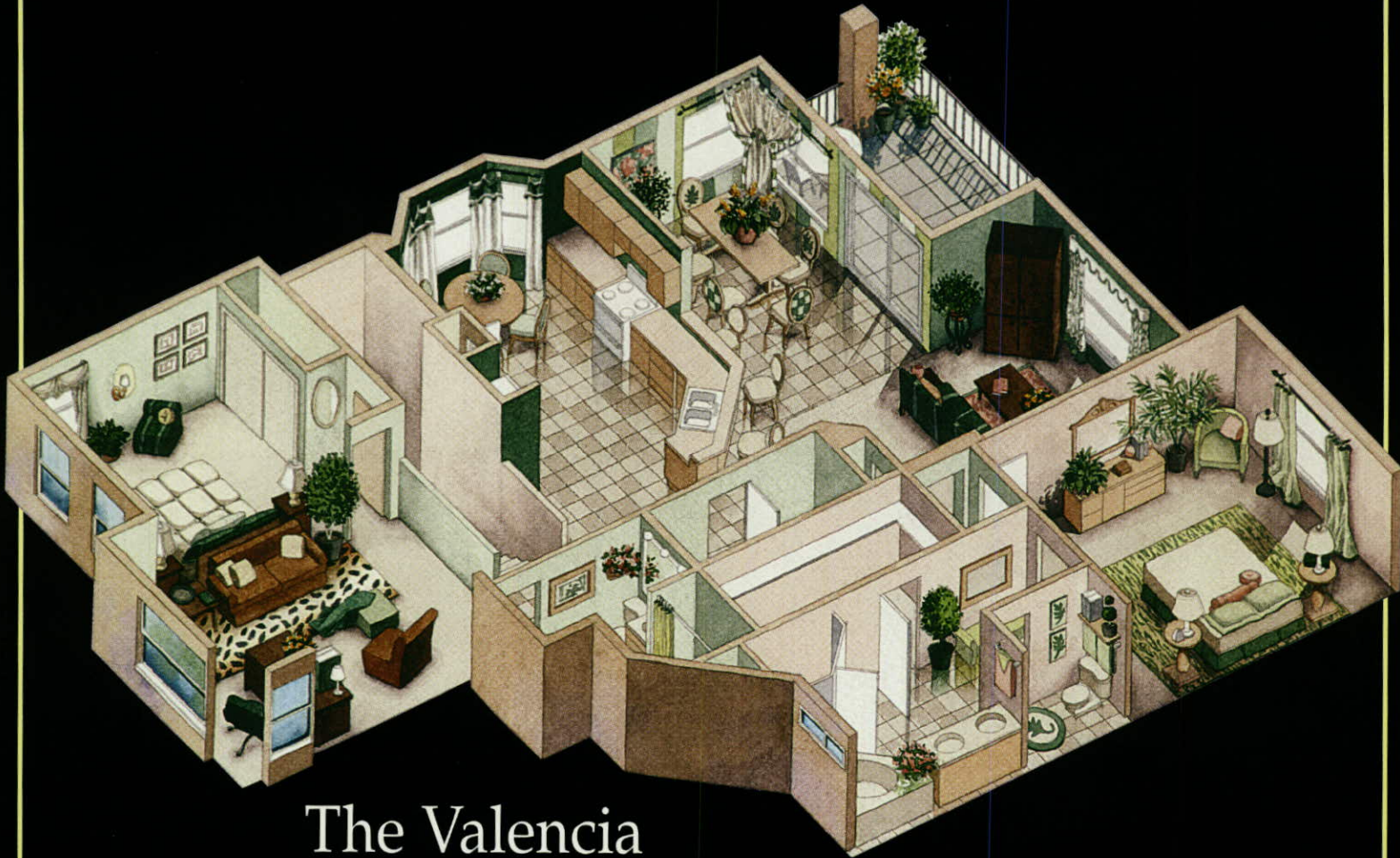

The Valencia  
Second Floor

|        |               |
|--------|---------------|
| Living | 1,769 Sq. Ft. |
| Garage | 248 Sq. Ft.   |
| Lanai  | 128 Sq. Ft.   |
| Total  | 2,145 Sq. Ft. |



## Spanish Wells

Spanish Wells is wonderfully located, just 1/4 mile East of U.S 41 on the South side of Bonita Beach Road. For direct access from Interstate 75, use Exit 18, West to Spanish Wells.

For more information about the various neighborhoods and residential styles of Spanish Wells, call (941) 992-6024 or, from out of town, 800-342-3323.

YOUR COMMUNITY OF TRADITIONAL HOME VALUES



# SPANISH WELLS

## Floorplan Worksheet

BROKER PARTICIPATION  
ENCOURAGED. ORAL  
REPRESENTATIONS  
CANNOT BE RELIED UPON  
AS CORRECTLY STATING  
REPRESENTATIONS OF THE  
DEVELOPER. FOR CORRECT  
REPRESENTATIONS,  
MAKE REFERENCE TO THE  
PURCHASE AGREEMENT  
AND TO THE DOCUMENTS  
REQUIRED BY SECTION  
718.503, FLORIDA STAT-  
UTES. TO BE FURNISHED  
BY A DEVELOPER TO A  
BUYER OR LESSEE.

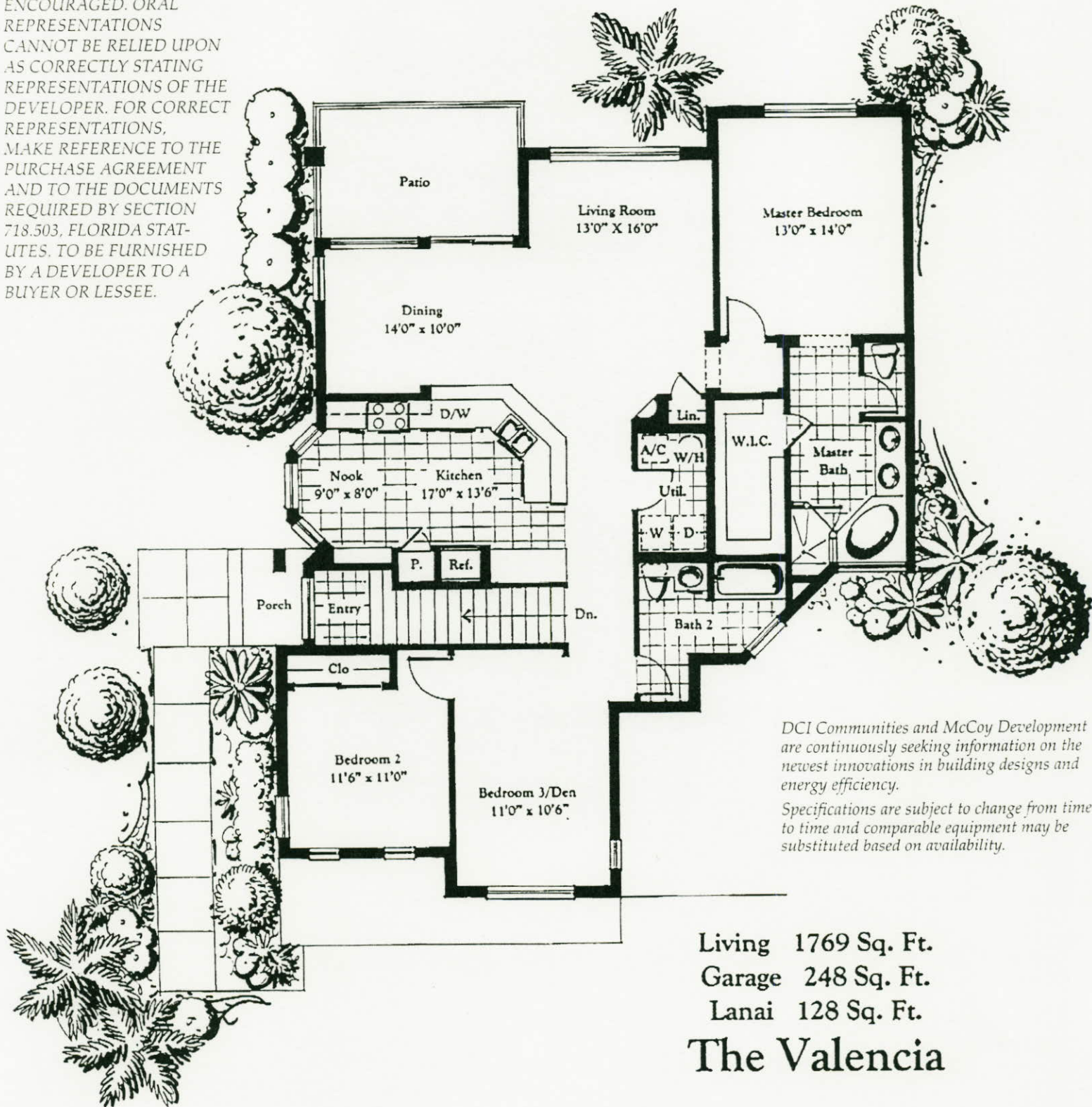

DCI Communities and McCoy Development are continuously seeking information on the newest innovations in building designs and energy efficiency.

Specifications are subject to change from time to time and comparable equipment may be substituted based on availability.

Living 1769 Sq. Ft.

Garage 248 Sq. Ft.

Lanai 128 Sq. Ft.

**The Valencia**