

London Bay Homes

The Ravenna



Artist's Conception

This Mediterranean home is the perfect blend of traditional design elements and state-of-the-art conveniences. From the banded stucco details of the front elevation to the water features used throughout the home, to the gourmet kitchen, integrated sound system, and pre-wiring throughout the home for state-of-the-art audio-visual, lighting and security systems, this is a home that really works for today's lifestyle. The dramatic vaulted foyer proclaims that this is no ordinary home, and the Saturnia floors with natural stone inlays and fabric-draped dining room columns confirm the fact. The kitchen features a Sub-Zero refrigerator and freezer, a six-burner professional range for the gourmet cook and a granite island. The breakfast room overlooking the pool is bathed in

light from the mitred windows. The family room with views over the pool and fairway contains a built-in entertainment center and a detailed octagonal wood ceiling. The master bathroom with its comfortable seating area and mullied glass windows also has views of the golf course, lake and pool and includes a boutique closet and morning kitchen. The master bath has a private garden, natural stone shower and whirlpool bath under a vaulted skylight. However, guests are not forgotten; they are provided with their own private foyer to their suite, which includes a Saturnia shower wall and a boutique closet. The family room is open on two sides with sliding glass and overlooks the golf course. It features a custom-built entertainment center with a 55" television surrounded

by cabinets and a dramatic detailed wood ceiling treatment. Close by the family room, a well-equipped summer kitchen with a large grill and refrigerator encourages outdoor living, while the custom designed pool features ornate water runnels reminiscent of Andalusia and the cool beauty of the Alhambra. The gentle splash of the fountains and the timelessness of the architecture come together to soothe even the most jaded of senses in this very enticing home.



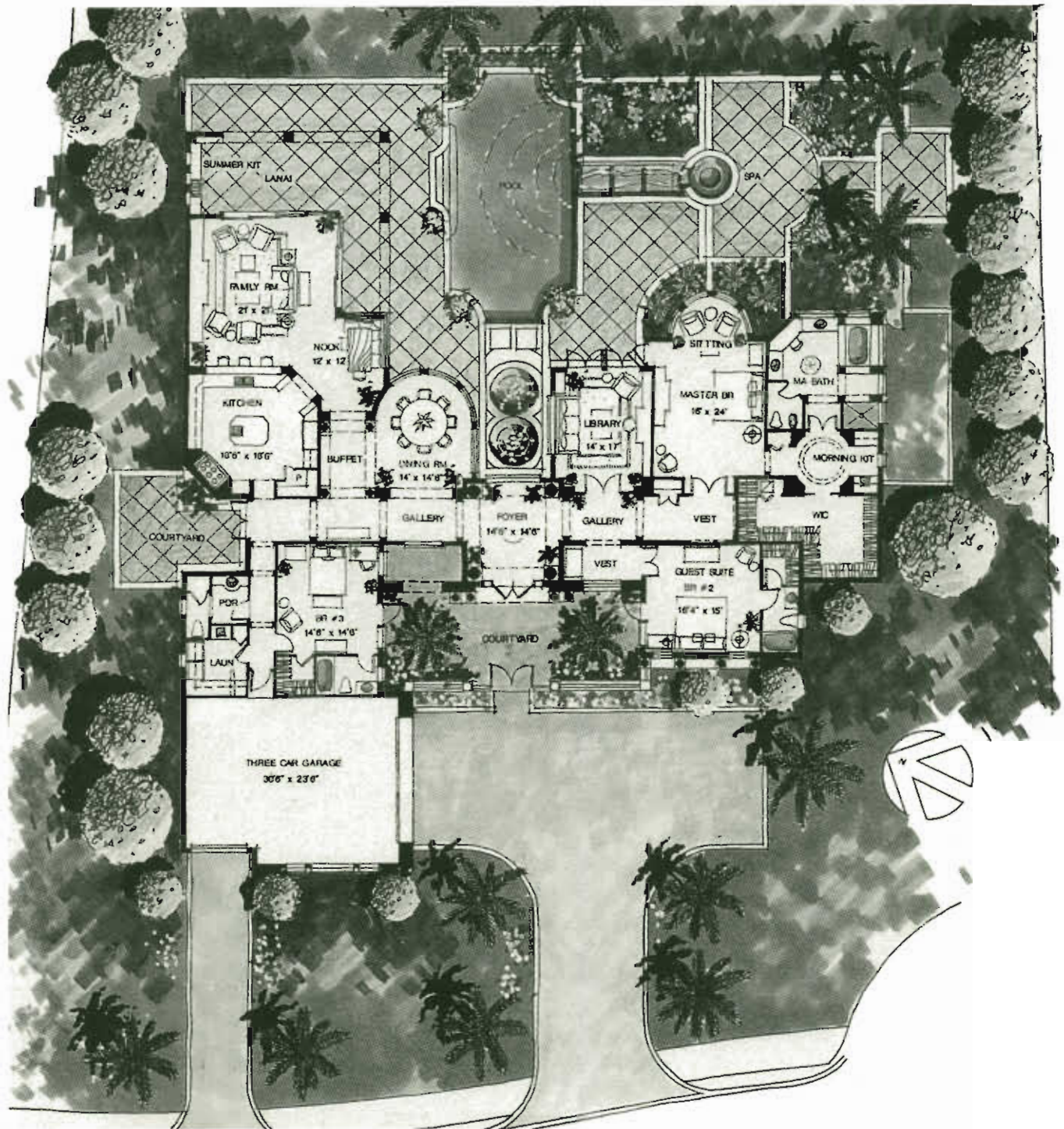

The Ravenna	
Living Area	3,994 sq. ft.
Garage	717 sq. ft.
Other Non Air-Conditioned Areas	598 sq. ft.
Total	5,309 sq. ft.

All dimensions and specifications are approximate, and subject to change without notice.