

Gulfshore Homes

The Marquesa



Artist's Conception

The Marquesa by Gulfshore Homes is a Mediterranean-style estate home encompassing 5,585 square feet of air conditioned living space and 7,588 total square feet.

This stately residence has four bedrooms, five baths and a powder room as well as a three-car garage with additional space for a golf cart. The master suite is complete with a sitting room, his and her walk-in closets and a spacious bath with Roman tub, separate

shower and sauna. A kitchen located at the rear of the home features custom-finished cabinetry, granite counter tops, professional grade appliances and views of the first green. Faux finish details and marble and granite are used extensively throughout the residence. A spectacular architectural pool and spa area includes a large entertaining terrace which provides dramatic perspectives of the verdant fairway and preserves beyond.

An ideal residence for both lavish entertaining and a private retreat, The Marquesa is available at \$2.4 million pre-construction.



Golf & Country Club

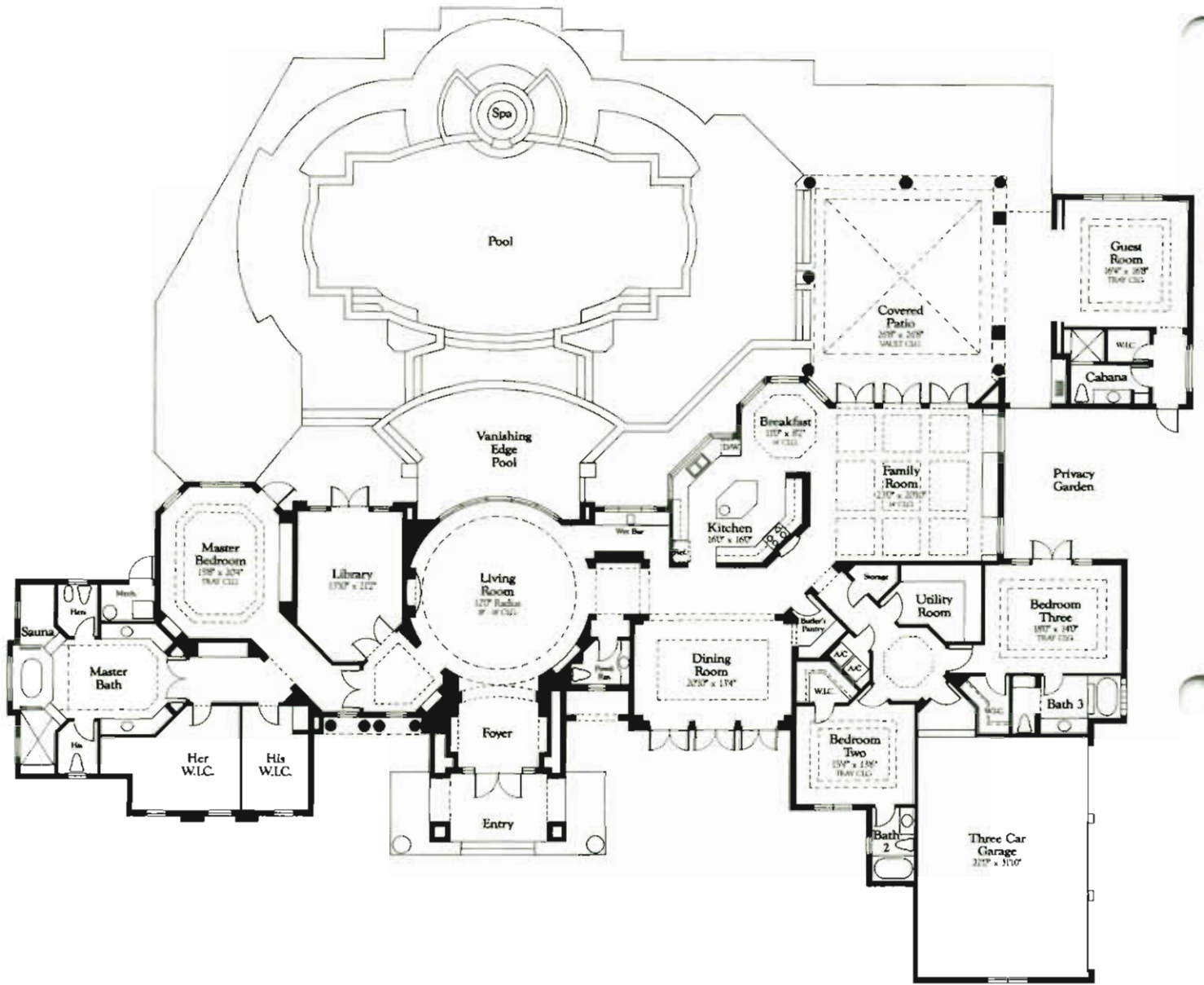

The Marquesa

Living Area	5,585 sq. ft.
Garage	800 sq. ft.
Entry	148 sq. ft.
Covered Patios	1,055 sq. ft.
Total	7,588 sq. ft.

All dimensions and specifications are approximate, and subject to change without notice.